

DETAIL B

Close spaced traffic cones, max spacing 1.2m between cone centres for type A cones and 5m for type B cones. Road cones should be recommended for the initial closure of the right hand lane(s) even if 750mm cones are used elsewhere.
 NB. Road Danger Lamps complying with Regulation 43 should be provided between the cones at 5m spacing during darkness.

DETAIL C

750mm or 1m high traffic cones
 NB. Road Danger Lamps complying with Regulation 43 should be provided between the cones at 15m spacing during darkness

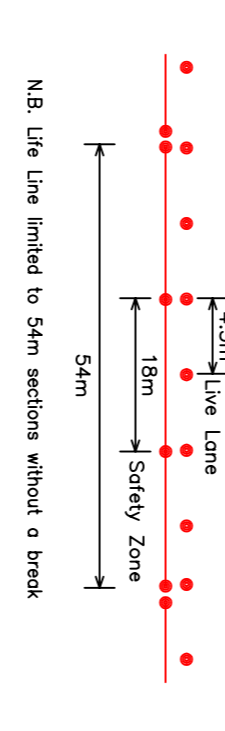

P610

NB. Repeater cones should be placed at 400m spacing

Temporary Traffic Management to be monitored to fully comply with chapter 8 when a work datum point is provided.

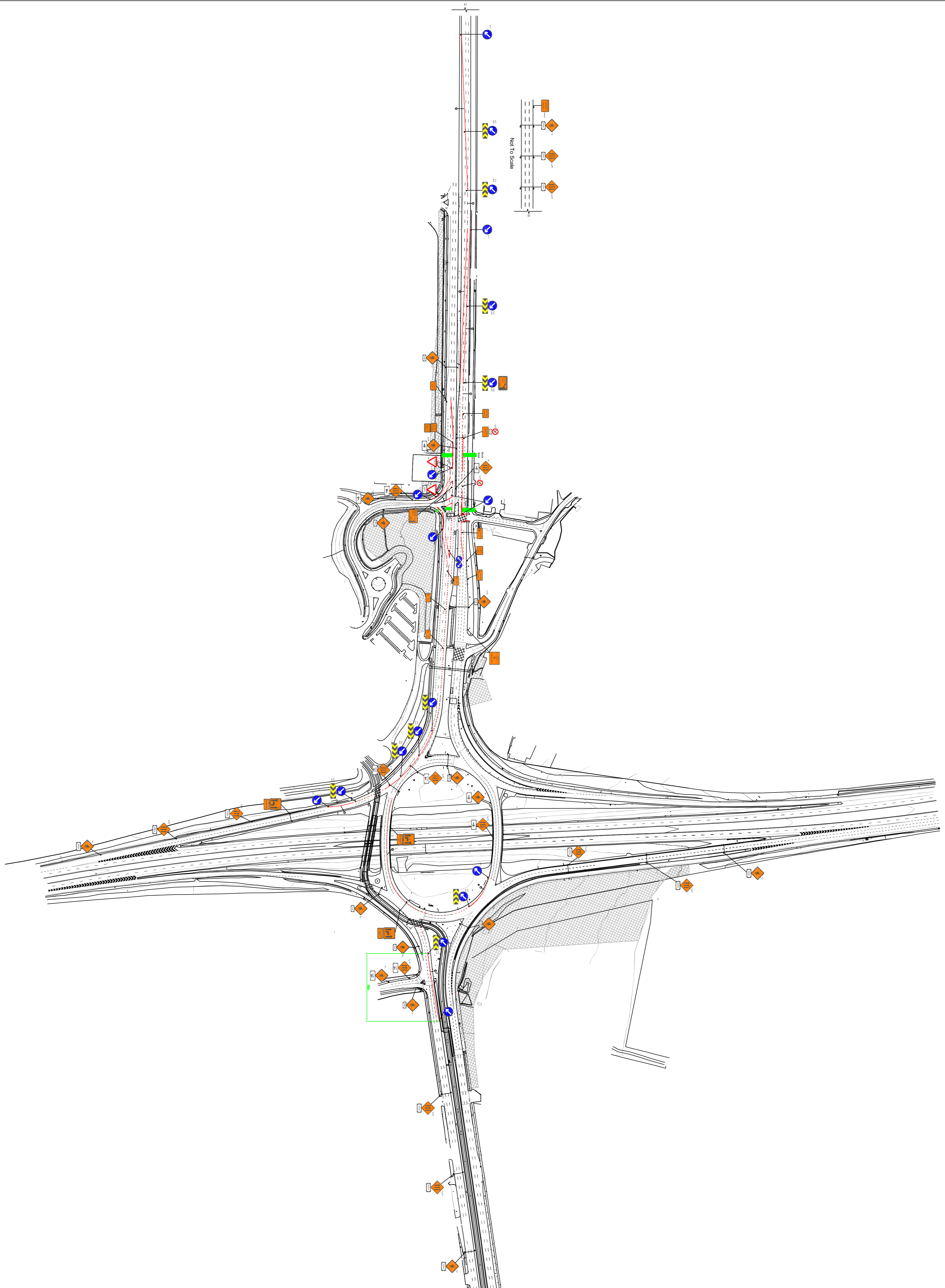

REV	DESCRIPTION	BY	DATE
A	Alterations as per Awp and STIC instructions	S.J.C	12.06.06
B	New Hoisting Arrangement	S.J.C	16.06.06

**M50 UPGRADE SCHEME 1
 JOINT VENTURE**

**UTILITY DIVERSIONS
 N7 PHASE 2 OVERALL**

COMPLETE HIGHWAY M/TENANCE

SC TRAFFIC MANAGEMENT SERVICES Ltd Traffic Management Consultants			
1 Derwent Avenue, Stone, Staffordshire, ST15 8FX.			
		Tel/FAX: 01785 811 510 Mobile: 07766 054 989	
Drawn by	Date	Project No	Dwg No
S CORNWALL	16.06.06	0069	007
Checked by	Plot Date	Scale	
BE	16.06.06	1:2500	